

Select the larger V-Seal when the dimension  $d_1$  is on the boundary between two sizes of V-Seal. All dimensions in inches.

V-Seal Designation	For Shaft Diameter $d_1$	Inside Diameter $d$	Height of Cross-Section $c$	Dimension A	Free Width B	Maximum $d_2$	Minimum $d_3$	Fitted Width $B_1$
V-3A	0.11 -0.14	0.10	0.06	0.08	0.12	$d_1 +0.04$	$d_1 +0.16$	0.10±0.012
V-4A	0.14 -0.18	0.13	0.08	0.09	0.15		$d_1 +0.25$	0.12±0.016
V-5A	0.18 -0.21	0.16						
V-6A	0.21 -0.26	0.20						
V-7A	0.26 -0.31	0.24						
V-8A	0.31 -0.37	0.28	0.08	0.09	0.15	$d_1 +0.04$	$d_1 +0.25$	0.12±0.016
V-10A	0.37 -0.45	0.35	0.12	0.13	0.22	$d_1 +0.08$	$d_1 +0.35$	0.18±0.02
V-12A	0.45 -0.49	0.41						
V-13A	0.49 -0.53	0.46						
V-14A	0.53 -0.61	0.49						
V-16A	0.61 -0.69	0.55						
V-18A	0.69 -0.75	0.63	0.12	0.13	0.22		$d_1 +0.35$	0.18±0.02
V-20A	0.75 -0.83	0.71	0.16	0.18	0.30		$d_1 +0.45$	0.24±0.03
V-22A	0.83 -0.95	0.79						
V-25A	0.95 -1.07	0.87						
V-28A	1.07 -1.14	0.98				$d_1 +0.08$		
V-30A	1.14 -1.22	1.06				$d_1 +0.12$		
V-32A	1.22 -1.30	1.14						
V-35A	1.30 -1.42	1.22						
V-38A	1.42 -1.50	1.34	0.16	0.18	0.30		$d_1 +0.45$	0.24±0.03
V-40A	1.50 -1.70	1.42	0.20	0.21	0.35		$d_1 +0.60$	0.28±0.04
V-45A	1.70 -1.89	1.57						
V-50A	1.89 -2.09	1.77						
V-55A	2.09 -2.29	1.93						
V-60A	2.29 -2.48	2.13						
V-65A	2.48 -2.68	2.28	0.20	0.21	0.35	$d_1 +0.12$	$d_1 +0.60$	0.28±0.04
V-70A	2.68 -2.88	2.48	0.24	0.26	0.43	$d_1 +0.16$	$d_1 +0.70$	0.35±0.05
V-75A	2.88 -3.07	2.64						
V-80A	3.07 -3.27	2.83						
V-85A	3.27 -3.47	2.99						
V-90A	3.47 -3.66	3.19						
V-95A	3.66 -3.86	3.35						
V-100A	3.86 -4.14	3.54	0.24	0.26	0.43		$d_1 +0.70$	0.35±0.05
V-110A	4.14 -4.53	3.90	0.28	0.31	0.50		$d_1 +0.80$	0.41±0.06
V-120A	4.53 -4.92	4.25						
V-130A	4.92 -5.32	4.61						
V-140A	5.32 -5.71	4.96						
V-150A	5.71 -6.10	5.31	0.28	0.31	0.50	$d_1 +0.16$	$d_1 +0.80$	0.41±0.06
V-160A	6.10 -6.50	5.67	0.32	0.35	0.57	$d_1 +0.20$	$d_1 +0.95$	0.47±0.07
V-170A	6.50 -6.89	6.02						
V-180A	6.89 -7.29	6.38						
V-190A	7.29 -7.68	6.73						
V-199A	7.68 -8.27	7.09	0.32	0.35	0.57	$d_1 +0.20$	$d_1 +0.95$	0.47±0.07
V-200A	7.48 -8.27	7.09	0.59	0.56	0.98	$d_1 +0.39$	$d_1 +1.75$	0.79±0.16
V-220A	8.27 -9.25	7.80						
V-250A	9.25 -10.43	8.86						
V-275A	10.43 -11.42	9.72						
V-300A	11.42 -12.20	10.63						
V-325A	12.20 -13.19	11.50						
V-350A	13.19 -14.37	12.40						
V-375A	14.37 -15.35	13.27						
V-400A	15.35 -16.93	14.17						
V-450A	16.93 -18.90	15.94						
V-500A	18.90 -20.87	17.72						
V-550A	20.87 -22.83	19.349						
V-600A	22.83 -24.80	21.26						
V-650A	24.80 -26.18	23.62						
V-700A	26.18 -27.76	24.80						
V-725A	27.76 -29.33	26.38						
V-750A	29.33 -30.91	27.76						
V-800A	30.91 -32.68	29.33						
V-850A	32.68 -34.45	30.91						
V-900A	34.45 -36.22	32.48						
V-950A	36.22 -37.99	34.06						
V-1000A	37.99 -39.96	35.83						
V-1050A	39.96 -41.93	37.60						
V-1100A	41.93 -43.90	39.37						
V-1150A	43.90 -45.87	41.14						
V-1200A	45.87 -47.84	42.91						
V-1250A	47.84 -50.00	44.69						
V-1300A	50.00 -51.97	46.46						
V-1350A	51.97 -53.94	48.23						
V-1400A	53.94 -55.91	50.00						
V-1450A	55.91 -57.87	51.77						
V-1500A	57.87 -59.84	53.54						
V-1550A	59.84 -61.81	55.32						
V-1600A	61.81 -63.78	57.09						
V-1650A	63.78 -65.75	58.86						
V-1700A	65.75 -67.72	60.63						
V-1750A	67.72 -69.69	62.40						
V-1800A	69.69 -71.65	64.17						
V-1850A	71.65 -73.62	65.95						
V-1900A	73.62 -75.59	67.72						
V-1950A	75.59 -77.56	69.49						
V-2000A	77.56 -79.53	71.26						

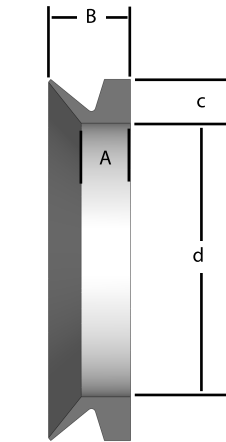

Profile dimensions

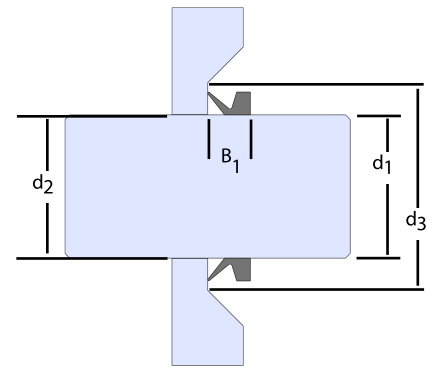

Assembly dimensions

V-Seal A larger than V-2000A are made to special order. Profile and axial fitted width are the same for V-200A -V2000A.